

Domestic & Commercial  
**SA Range**



Axial Flow **Fans**

# features & benefits



## SA range

The SA Axial Range is a stylish range of axial flow fans which provides powerful extract of air through windows, walls, ceilings and panels for a variety of domestic and commercial applications.

- 3 standard sizes from 100mm to 150mm.
- Air volume flow rates of up to 0.088 m<sup>3</sup>/s (317 m<sup>3</sup>/hr).
- Static pressures of up to 80 Pa.
- Axial impeller design for larger volumes.
- IPX4 – Splash proof.
- Shock proof, heat resistant plastic.
- Suitable for operating temperatures up to 40°C.
- Motors are double insulated with built-in thermal overload protection.
- CE Marked and BEAB approved.
- Sealed for life ball bearings to operate at any angle.
- Timer models adjustable from 3-15 minutes.
- Lower noise levels.

### Features & Benefits

**Motor protection** – Each SA motor is double insulated so no earth is required with integral thermal overload protection which prevents the motor from overheating.

**Range** - There are three sizes, 100mm, 125mm and 150mm.

**Options** - The SA range, dependant on model, incorporate silent, delayed action, slow moving electric shutters for silent opening and closing; a run on timer adjustable between 3 and 15 minutes; a dynamic type humidistat with anti-hunting feature; a passive infra-red detector; and can be operated via a pull cord.

**Safety** – SA fans are IPX4 Splash proof, protected against water splashing from all directions which means they can be safely installed in Zones I and II in accordance with IEE Wiring Regulations.

**Ease of installation** – Designed and supplied with all the necessary fixings, with unique features to make installation easier.

**Material strength** - Units are manufactured from shock proof, heat resistant white plastic, which is durable and non corrosive.

**Mounting** – Each unit is suitable for window, wall, panel or ceiling mounting installations.

**Full ancillary range** – Wall kits, window kits, fan locking rings.

**Reliability** – Motors have sealed for life bearings.

**Warranty** – Each SA has a 2 year warranty.

### Applications

Shower rooms, bathrooms, kitchens, utility rooms, residential and commercial facilities.

# product information



## SA range

	Product Code Description
SA100	Basic unit, fan only
SA100T	Run on timer unit
SA100C	Pull cord operated unit
SA100HCT	Humidistat, pull cord, timer and neon. The neon light is activated by the pull cord. This cord can be removed and the unit wired to activate via a light switch
SA100TPIR	Run on timer activated by personnel entry into room. Range 3m @ 110 degrees
SA100HTPIR	Humidistat plus run on timer activated by personnel entry into room
SA100A	Unit with silent electrically operating shutters
SA100AT	Unit with silent electrically operating shutters and run on timer
SA100AC	Unit with silent electrically operating shutters and pull cord
SA10AHCT	Unit with silent electrically operating shutters, humidistat, pull cord and run on timer. Unit has a neon activated via pull cord which can be removed and the unit wired to activate via a door or a light switch
SA125	Basic unit, fan only
SA125T	Run on timer unit
SA125C	Pull cord operated unit
SA125HCT	Humidistat, pull cord, timer and neon. The neon light is activated by the pull cord. This cord can be removed and the unit wired to activate via a light switch
SA125A	Unit with silent electrically operating shutters
SA125AT	Unit with silent electrically operating shutters and run on timer
SA125AC	Unit with silent electrically operating shutters and pull cord
SA125AHCT	Unit with silent electrically operating shutters, humidistat, pull cord and run on timer. Unit has a neon activated via pull cord which can be removed and the unit wired to activate via a door or a light switch
SA150	Basic unit, fan only
SA150T	Run on timer unit
SA150C	Pull cord operated unit
SA150AC	Unit with silent electrically operating shutters and pull cord
SA150HCT	Unit with silent electrically operating shutters, humidistat, pull cord and run on timer. Unit has a neon activated via pull cord which can be removed and the unit wired to activate via a door or a light switch

Product Code	Voltage	Maximum Volume		Mounting Arrangement			Operation						
		l/sec	m <sup>3</sup> /hr	Ceiling	Wall	Window	Fan Only	Pull Cord	Run on Timer	Electric Shutter	Humidistat	PIR	
SA100	230	27	97	√	√	√	√						
SA100T	230	27	97	√	√	√	√		√				
SA100C	230	27	97	√	√	√	√	√					
SA100HCT	230	27	97	√	√	√	√	√	√			√	
SA100TPIR	230	27	97	√	√	√	√		√				√
SA100HTPIR	230	27	97	√	√	√	√		√			√	√
SA100A	230	27	97	√	√	√	√				√		
SA100AT	230	27	97	√	√	√	√		√		√		
SA100AC	230	27	97	√	√	√	√	√			√		
SA100AHCT	230	27	97	√	√	√	√	√	√	√		√	
SA125	230	53	191	√	√	√	√						
SA125T	230	53	191	√	√	√	√		√				
SA125C	230	53	191	√	√	√	√	√					
SA125HCT	230	53	191	√	√	√	√	√	√			√	
SA125A	230	53	191	√	√	√	√				√		
SA125AT	230	53	191	√	√	√	√		√		√		
SA125AC	230	53	191	√	√	√	√	√			√		
SA125AHCT	230	53	191	√	√	√	√	√	√	√		√	
SA150	230	88	317	√	√	√	√						
SA150T	230	88	317	√	√	√	√		√				
SA150C	230	88	317	√	√	√	√	√					
SA150AC	230	88	317	√	√	√	√	√			√		
SA150HCT	230	88	317	√	√	√	√	√	√			√	

Note: The SA Range is not suitable for Duct or Roof mounting

## SA range

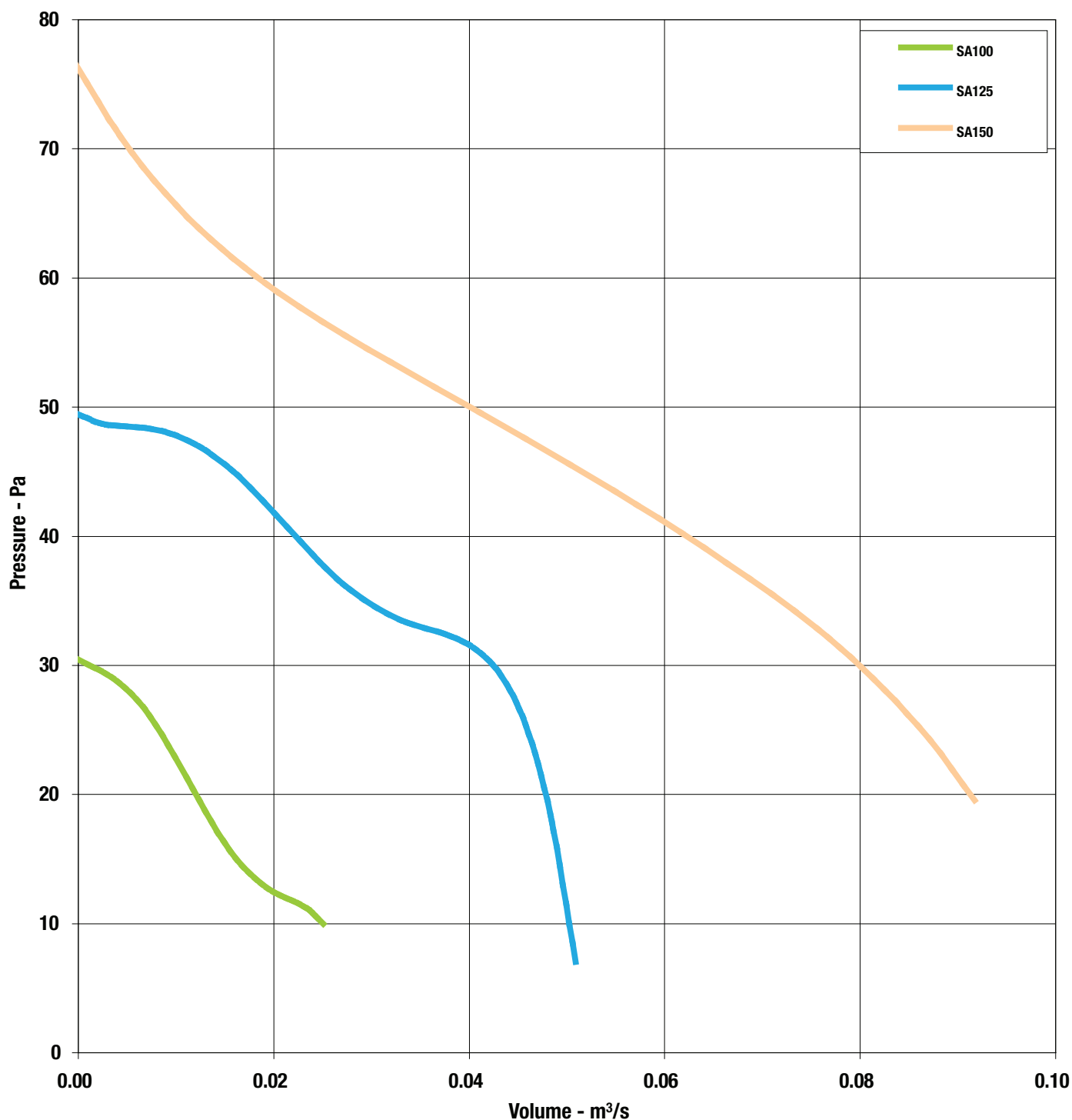

Model	SA100	SA125	SA150
Diameter.	100mm	125mm	150mm
Volts.	230	230	230
Watts.	15	20	25
r/min	2500	2450	2100
l/sec.	27	53	88
Max Pa.	30	50	80
dBA @ 3m	41	43	43

# dimensional data

## SA range

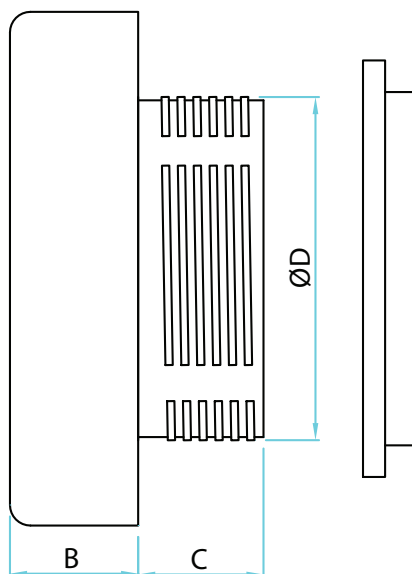
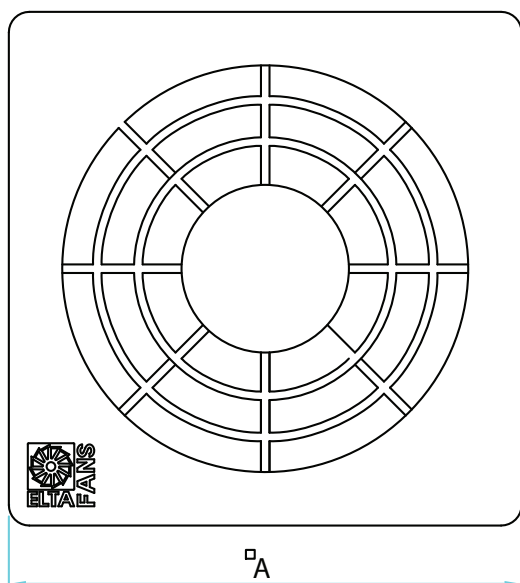

Product Code	A	B	C	D	Weight kg
SA100	150	35	42	98	1.0
SA125	180	44	45	118	1.2
SA150	210	45	60	148	1.4

# dimensional data

## SA ELSHUT range

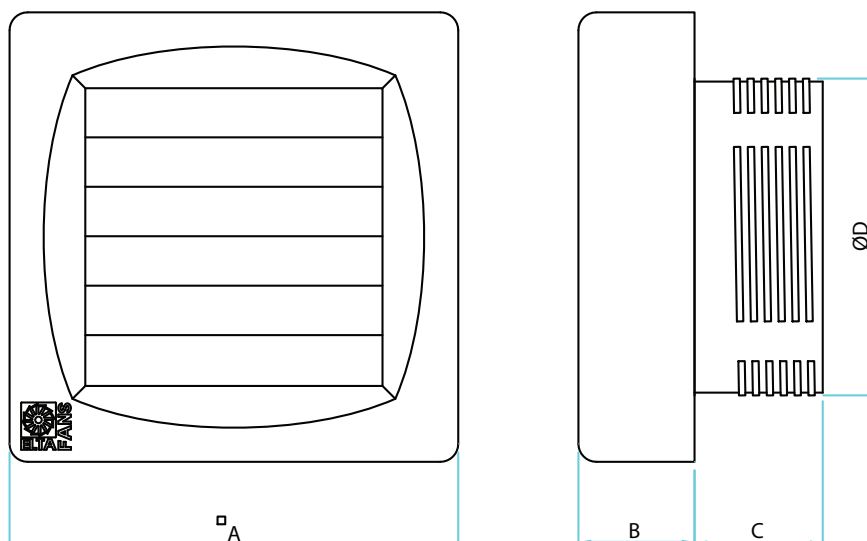

Product Code	A	B	C	D	Weight kg
SA100A	150	50	42	98	1.0
SA125A	180	62	45	118	1.2
SA150A	210	64	60	148	1.4

# dimensional data

## SA PIR range

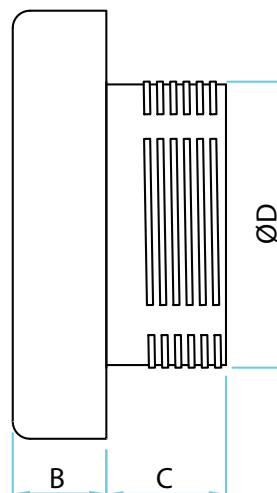
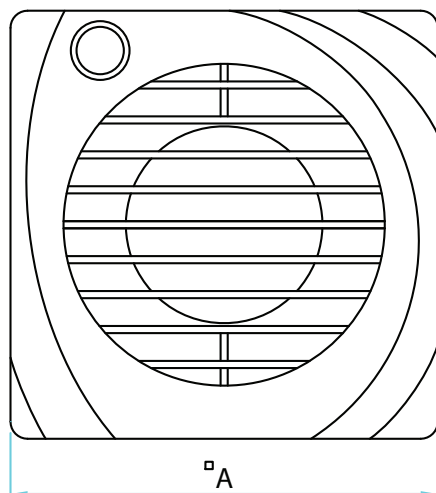

Product Code	A	B	C	D	Weight kg
SA100TPIR	150	35	42	98	1.0

## flexible wall sleeve kit



- Comprises durable white plastic grille for external mounting
- 3 metres of pvc flexible duct

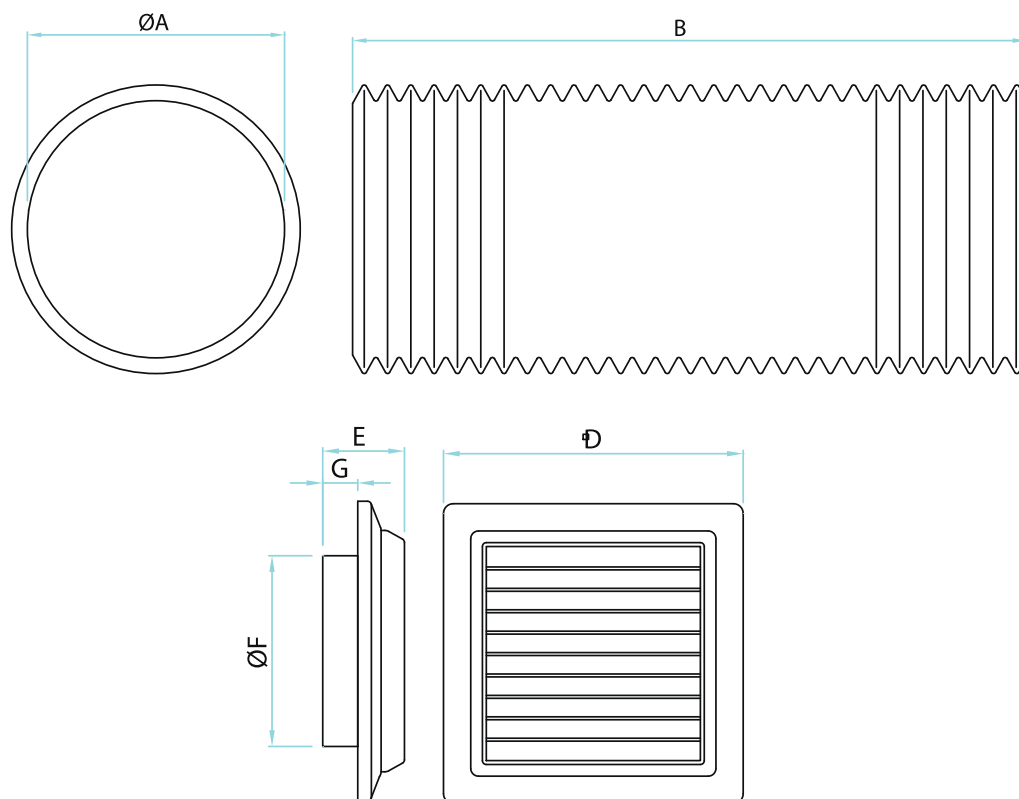

Product Code		A	B	Weight kg		D	E	F	G	Weight kg
SK100SAWKFlex	FLEX 100	100	356	0.305	GRILLE 100	154	42	98	18	0.114
SK125SAWKFlex	FLEX 125	125	356	0.385	GRILLE 125	200	58	123	28	0.210
SK150SAWKFlex	FLEX 150	150	356	0.474	GRILLE 150	200	58	148	28	0.210

# accessories

## external wall grille

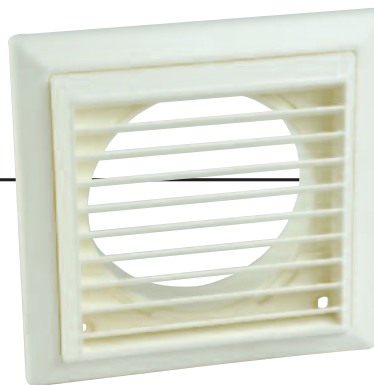

- Durable white plastic
- Mounted independantly of fan

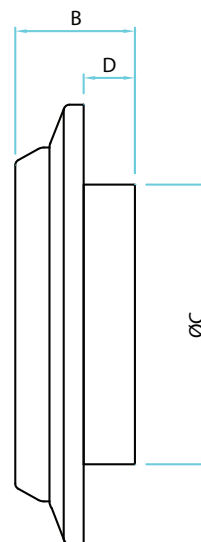
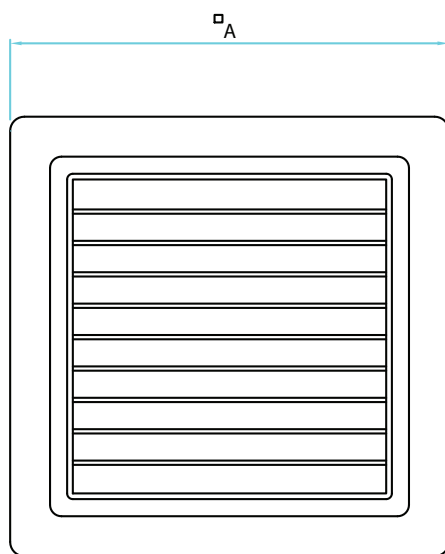

Product Code	A	B	C	D	Weight kg
SKGW-100D	154	42	98	18	0.114
SKGW-125D	200	58	123	28	0.210
SKGW-150D	200	58	148	28	0.210

# fan locking ring

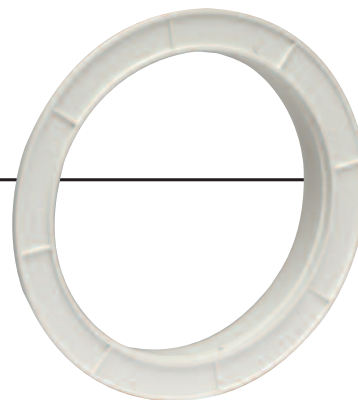

- Durable white plastic
- Fits directly to fan allowing easy installation without fixing screws

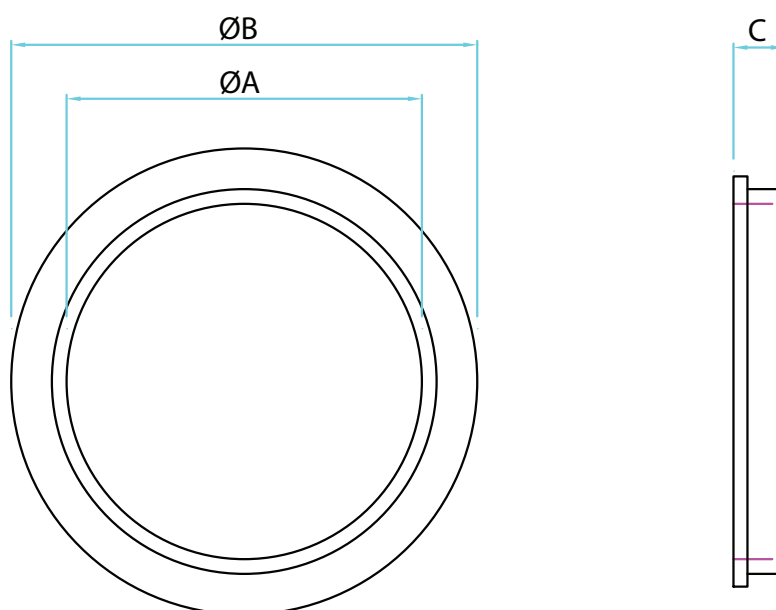

Product Code	A	B	C	Weight kg
SK100SACR	100	132	15	0.048
SK125SACR	125	155	26	0.075
SK150SACR	150	187	26	0.100



- Durable white plastic
- Opens automatically with airflow
- Mounted independently of fan

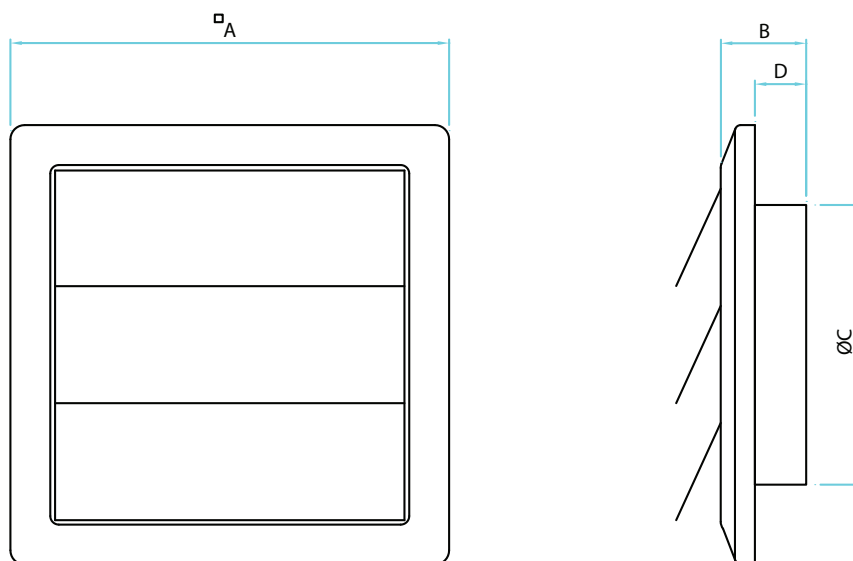

Product Code	A	B	C	D	Weight kg
SKFLW-100D	154	42	98	18	0.078
SKFLW-125D	200	58	123	28	0.178
SKFLW-150D	200	58	148	28	0.182

# accessories

## telescopic kit



- Durable white plastic grille for external mounting and rigid, white plastic telescopic sleeve.
- Minimum length of 215mm and maximum length of 380mm

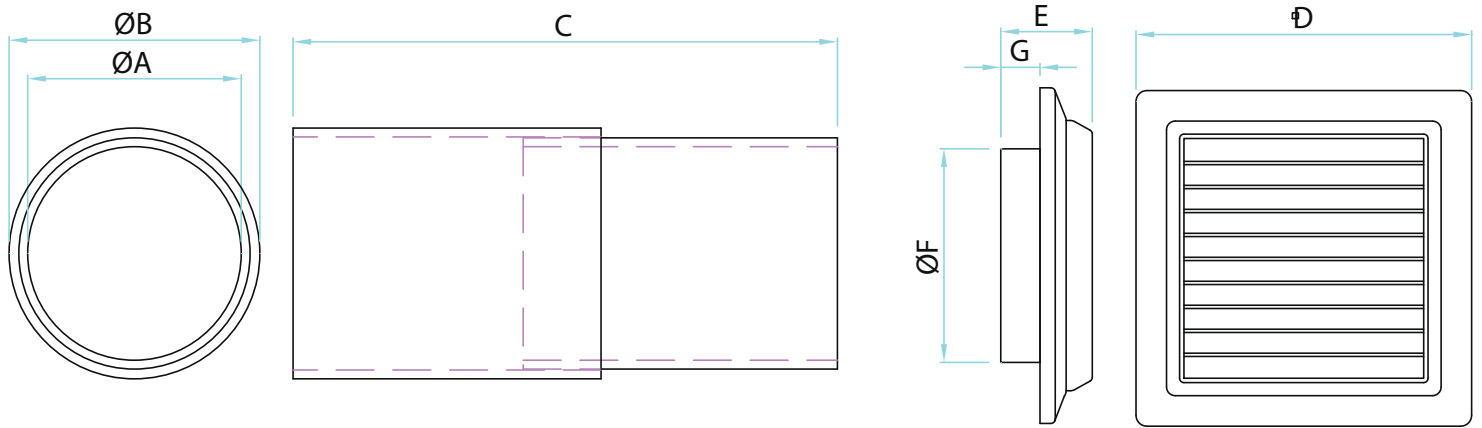

Product Code		A	B	C	Weight kg		D	E	F	G	Weight kg
SK100SAWKTLSCOP	SLEEVE 100	100	105	203/355	0.305	GRILLE 100	154	42	98	18	0.114
SK125SAWKTLSCOP	SLEEVE 125	125	130	203/355	0.385	GRILLE 125	200	58	123	28	0.210
SK150SAWKTLSCOP	SLEEVE 150	150	155	203/355	0.474	GRILLE 150	200	58	148	28	0.210

## single glazing kit

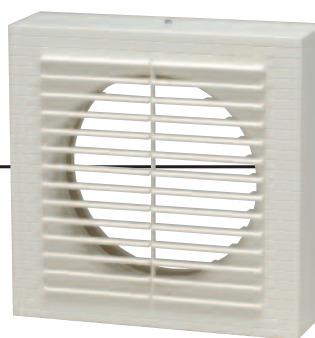

- Comprises durable white plastic external grille and ceiling ring
- Allowing easy installation without fixing screws

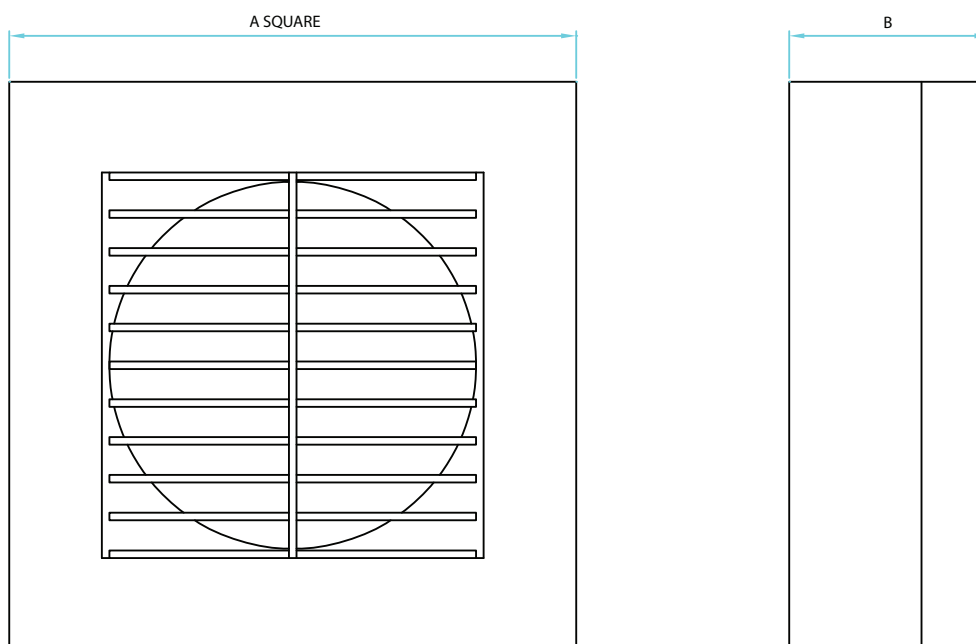

Product Code	A	B	Weight kg
SK100SAWKSG	150	53	0.195
SK120SAWKSG	180	56	0.280
SK150SAWKSG	208	70	0.380



**Elta Fans Ltd - Applied Technology**

17 Barnes Wallis Road,  
Segensworth East Industrial Estate,  
Fareham, Hampshire, P015 5ST, United Kingdom.

**Visit:** [eltafans.com](http://eltafans.com)

**e-mail:** [mailbox@eltafans.co.uk](mailto:mailbox@eltafans.co.uk)

**Applied Technology:**

**Tel:** +44 (0) 1489 566500

**Fax:** +44 (0) 1489 566555

**Building Services:**

**Tel:** +44 (0) 1384 275800

**Fax:** +44 (0) 1384 275810

**Export:**

**Tel:** +44 (0) 1489 566500

**Fax:** +44 (0) 1489 566555