

SERIES RD

Iris Duct Damper

PUBLICATION

DAMPERS 5

SEPT 2005

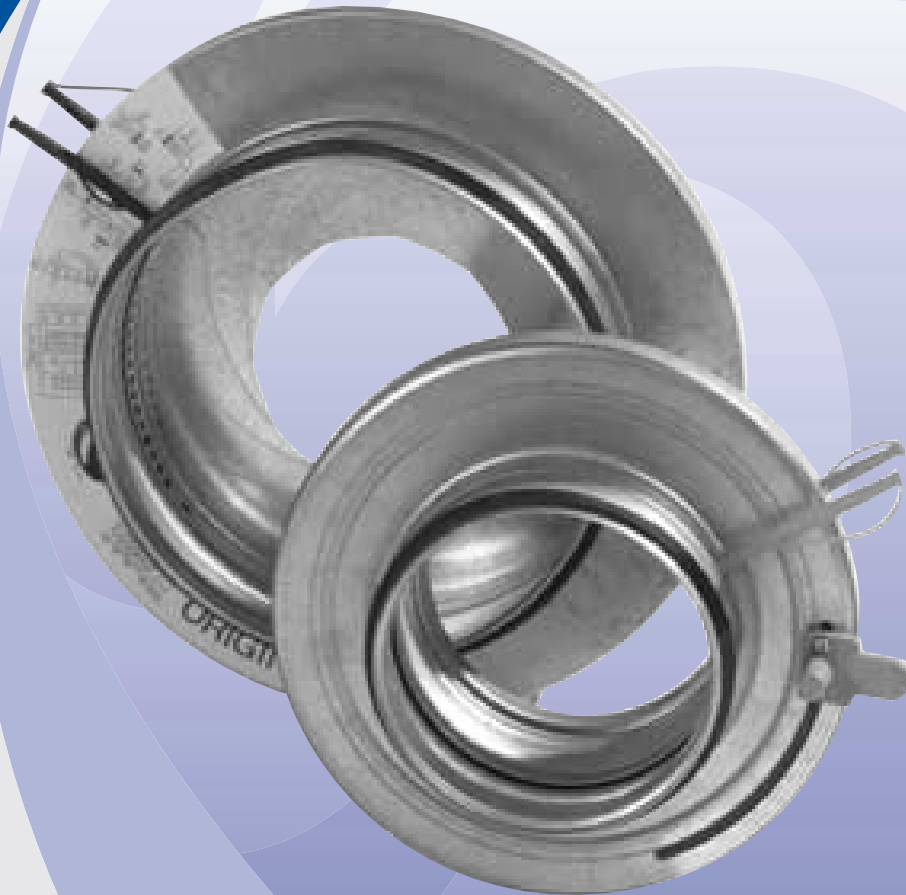

Features

- Accurate Volume Control.
- Smooth, Quiet Airflow.
- 12 Different Size Options.
- Differential Pressure Measuring Facility.
- Plenum or Duct Mounting.
- Robust Galvanised Steel Construction.



GILBERTS

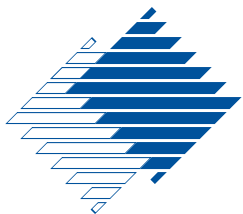

SERIES RD

Introduction

Gilberts series RD range of Iris Duct Dampers have been designed to provide smooth, even and accurate proportional balancing in all types of air ductwork. Unlike conventional opposed blade dampers, when closing Gilberts Iris Dampers offer a uniform reduction in duct cross sectional area giving the advantage of reduced noise and air turbulence generation characteristics. Their accuracy and size make them ideal for use not only in main ducts and branches but also in plenum box spigots and circular spigots on grilles and diffusers where accurate balancing may be

required. Available in twelve different duct diameters Gilberts Iris Dampers are manufactured wholly from galvanised steel to resist corrosion. Operation is achieved manually either via an operating lever (upto size 315) or a 17mm rotating nut (size 400 and up) on the outer casing where an adjustment scale indicates the damper aperture.

Features

- Accurate volume control.
- Smooth, quiet airflow.
- 12 different size options.
- Differential pressure measuring facility
- Plenum or duct mounting.
- Robust galvanised steel construction



Performance Data

Gilberts Iris Dampers as well as providing proportional balancing, offer the added benefit of being suitable for use as an air-flow measuring device on circular ducts based on the orifice plate principle. The accurate damper control mechanism ensures that the damper aperture matches exactly the scale on the damper casing. Manometer connections, which are fitted on

either side of the damper, can then be used to measure the pressure differential across the unit to an accuracy of $\pm 5\%$ corresponding flow rates can then be calculated in conjunction with the performance data.

Size Range

The RD Series is available in 12 different sizes ranging from 100mm dia up to 800mm dia. Please see dimensional information for details.

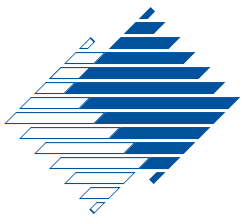

SERIES RD

Dimensional Data

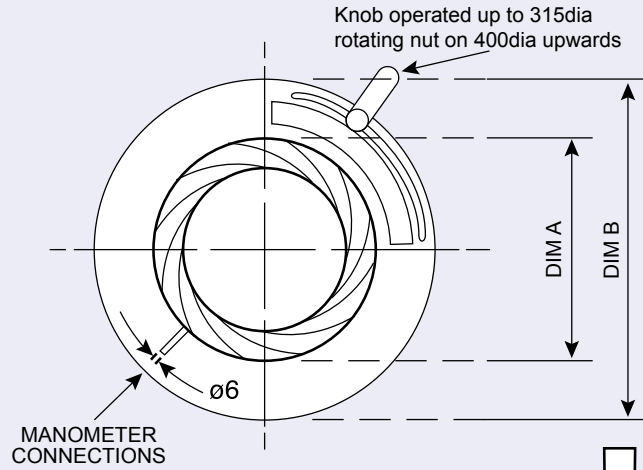

List Size	Dim A	Dim B	Dim C
100	99	165	115
125	124	210	120
150	149	230	110
160	159	230	120
200	199	285	125
250	249	335	125
300	299	410	120
315	314	420	120
400	398	525	190
500	498	655	170
630	628	815	170
800	798	1015	270

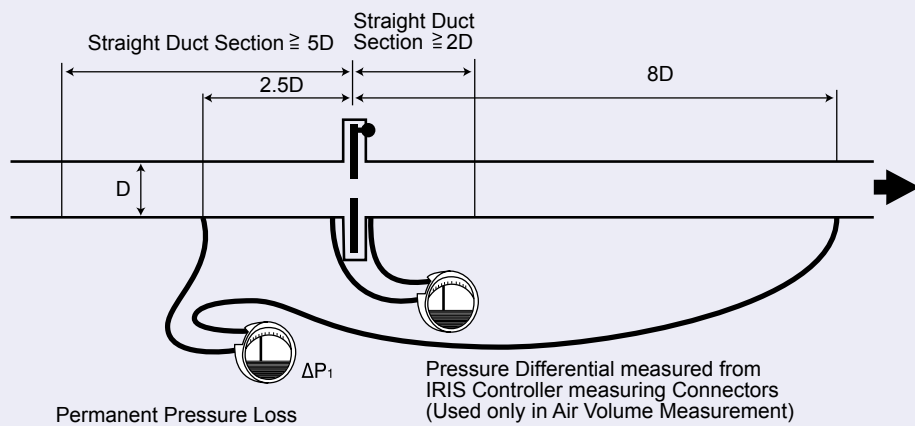
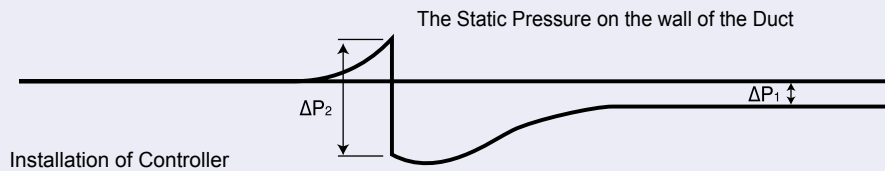
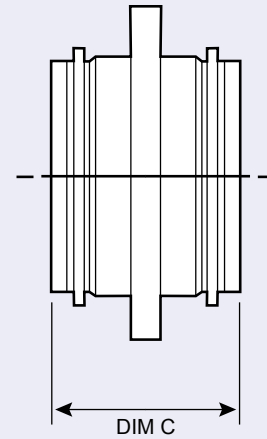

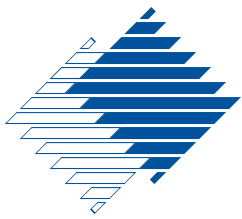

SERIES RD

Technical Performance Data

RD 100

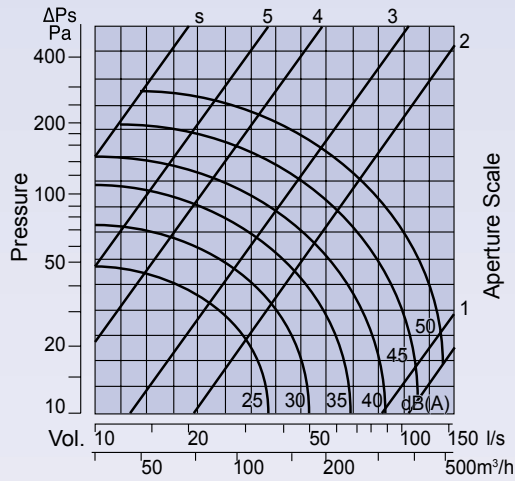

RD 125

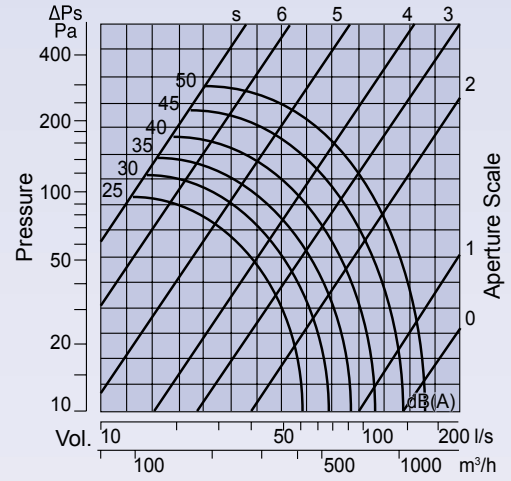

RD 150

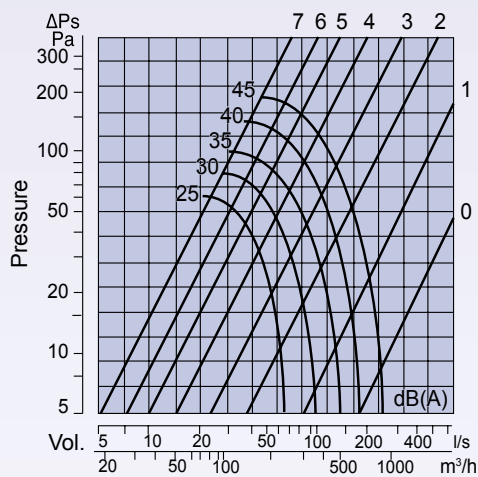

RD 160

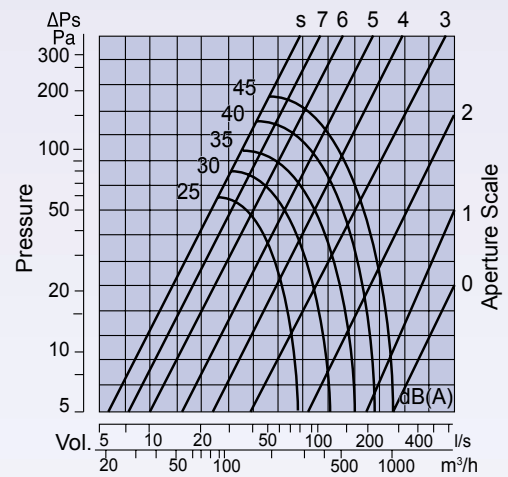

RD 200

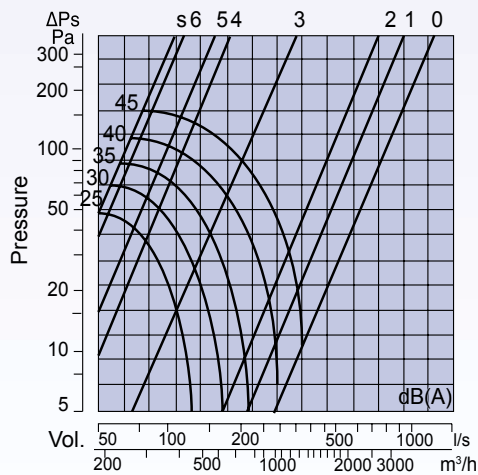

RD 250

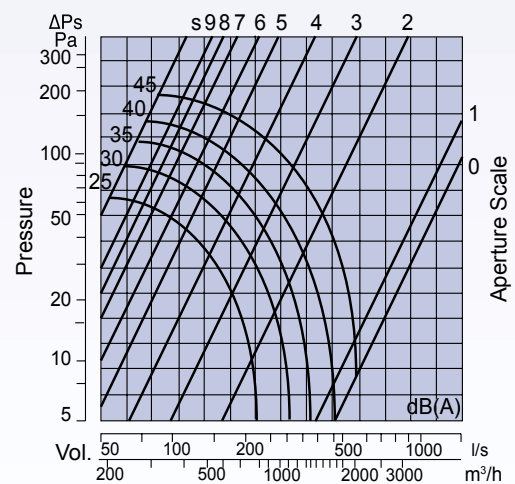

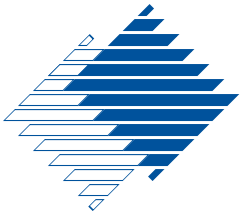

SERIES RD

Technical Performance Data

RD 300

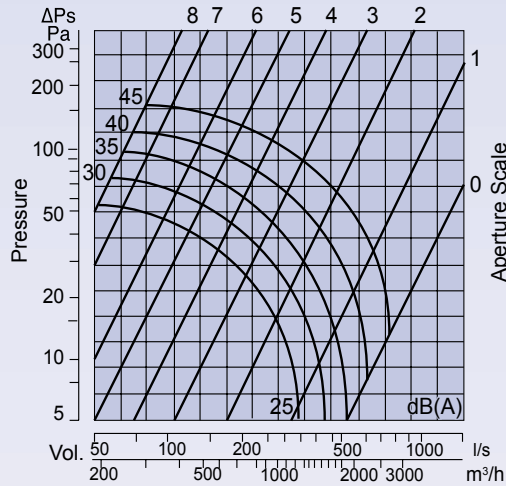

RD 315

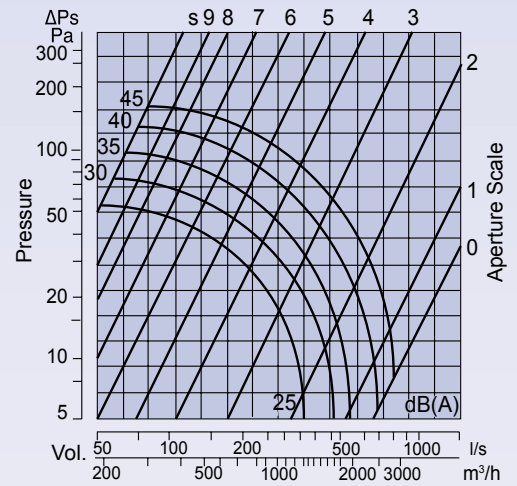

RD 400

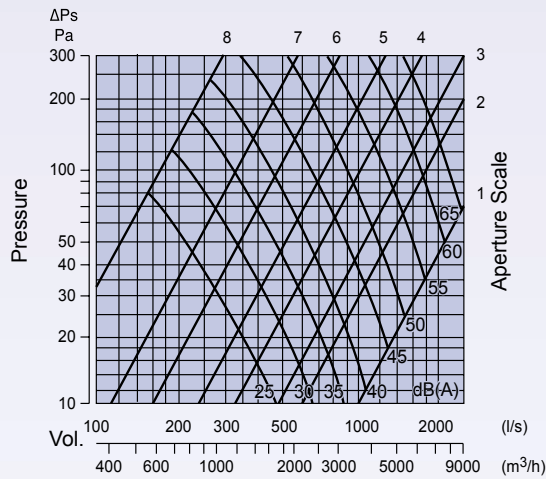

RD 500

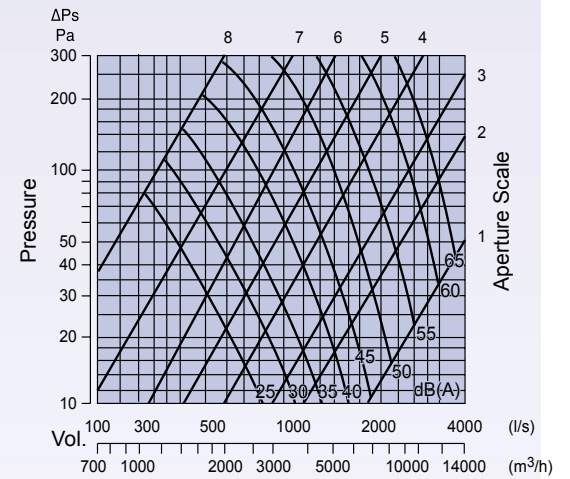

RD 630

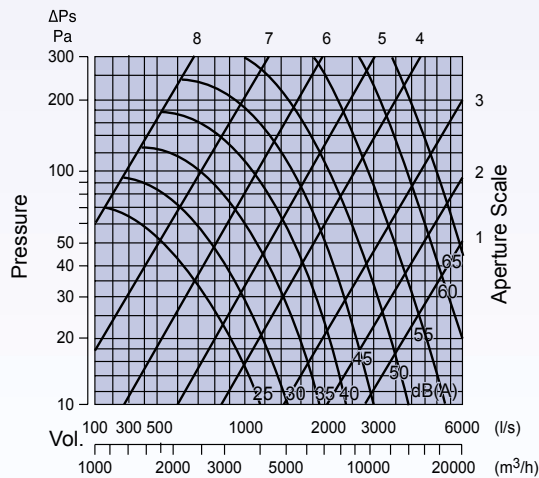

RD 800

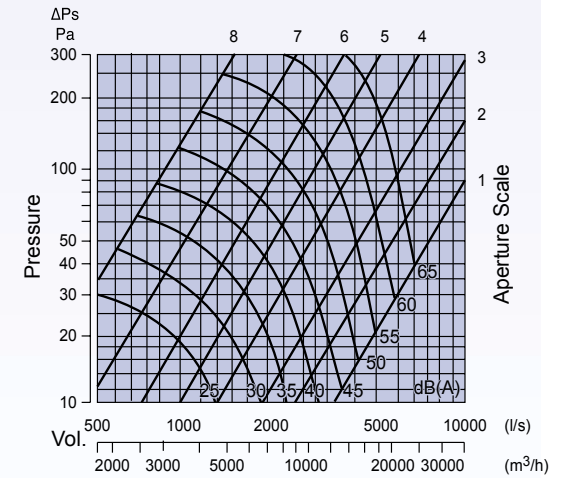

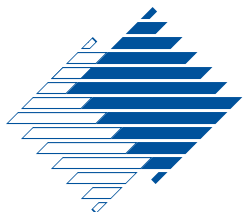

SERIES RD

Ordering Specification

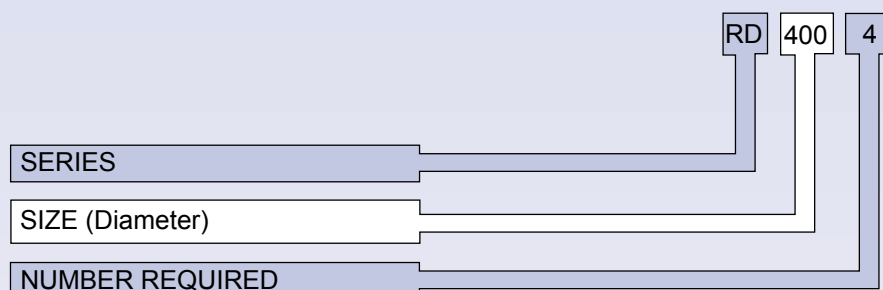

FIXING

Gilberts Iris Dampers are fixed into the ductwork through the damper collar either with rivets or self-tapping screws. Rubber gasketing on the collar does ensure a tight duct seal but additional sealant is recommended to ensure an airtight seal.

INSTALLATION

Ideally Iris dampers should be fitted into straight ductwork runs. In rigid ducting the unit can typically be fixed by rivets or self tapping screws. Joints should be sealed for an air tight connection. Where flexible ducting is used banding or clips can be used for attachment.

Contact

GILBERTS

Head Office and Works
GILBERTS (BLACKPOOL) LTD
Gilair Works, Clifton Road,
Blackpool.
Lancashire FY4 4QT.
Telephone: (01253) 766911
Fax: (01253) 767941
e-mail: sales@gilbertsblackpool.com
Web: www.gilbertsblackpool.com

