

# SERIES AV

## Door Transfer Grille

PUBLICATION

GRILLES 8

JUNE 2008

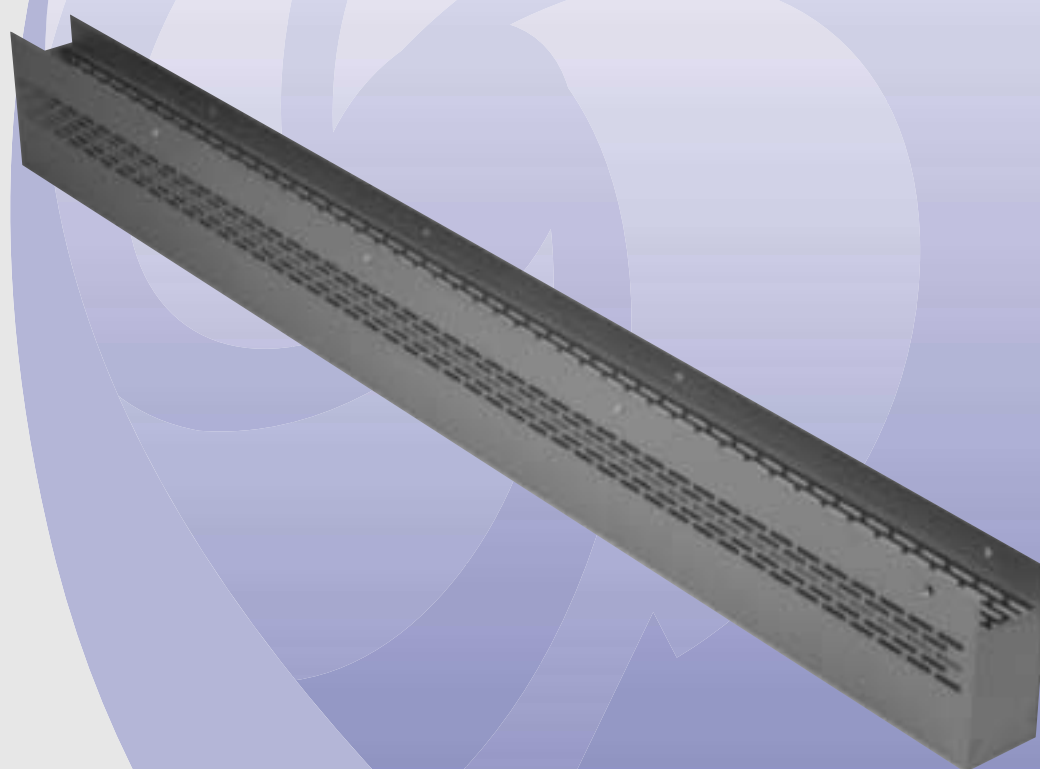

### Features

- Unique Discreet Door Base Design.
- Standard 900 or 1000mm Lengths.
- 35 or 44mm Door Thickness.
- All Extruded Aluminium Construction.



# GILBERTS

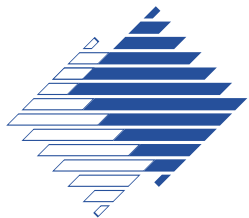

# SERIES AV

## Introduction

Gilberts AV1601 Series presents an attractive alternative to traditional vision proof door mounting air transfer grilles. Discreet, but attractive, this robust extruded aluminium grille incorporates a slotted, linear airway across its length and locates at the bottom of the door in the style of a baseplate. Utilising a dovetail slide feature the unit can be assembled to suit standard door thickness of either 35 or 44mm with matching end caps supplied. Available in standard 900 or 1000mm lengths the units can be ordered to size or more typically, trimmed on site to match individual door lengths. Standard finish is Satin Silver although special finishes such as Brass Anodised, to match door iron mongery, or other colour finishes can be supplied upon request.



## Dimensional Data

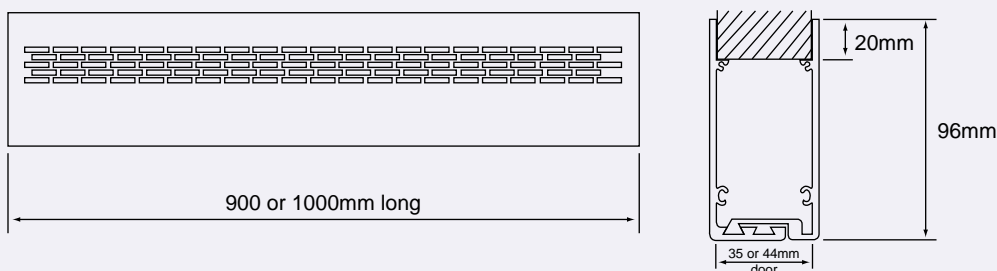

## Installation

1. First remove 75mm from the base of the door.
2. From the section of the door removed, extract the lower frame member, and refit into the base of the door.
3. The grille halves dovetail slide into each other and have adjustment for the door thickness of 35mm and 44mm. NOTE illustration 3 shows that one end of the two grille sections is factory recessed to accept the end plate which must be fitted to the leading edge of the door.
4. Cut grille to length to suit the width of the door. Ensure that the cut is made on the unrecessed ends of the grilles, otherwise flush fitting of the end plate will not be possible.
5. Fix grilles with the eight pozidrive screws supplied. Fix end plate with the four self tapping screws provided.

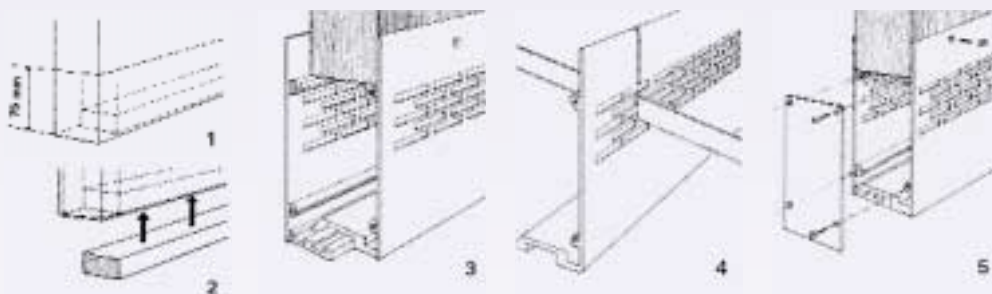

## Ordering Specification

SERIES:	AV1601	900	PPC SATIN SILVER (Standard Finish)	4
SIZE - 900mm, 1000mm:				
FINISH (Please specify):				
NUMBER REQUIRED				

## Sizing Finish

AV1601 units provide a free area of 96cm<sup>2</sup> per metre of length. Using 2m/s as a maximum jet velocity the suggested maximum volume for each metre of length is 19 litres/sec.

Standard Finish: PPC Satin Silver  
Special Finishes: PPC to Stock Ral or BS colour

## Contact

### GILBERTS

Head Office and Works  
**GILBERTS (BLACKPOOL) LTD**  
Gilair Works, Clifton Road,  
Blackpool.  
Lancashire FY4 4QT.  
Telephone: (01253) 766911  
Fax: (01253) 767941  
e-mail: [sales@gilbertsblackpool.com](mailto:sales@gilbertsblackpool.com)  
Web: [www.gilbertsblackpool.com](http://www.gilbertsblackpool.com)

